



MET Community Center

Bringing Community Together Since 1993

Muslim Educational Trust
10330 SW Scholls Ferry Road, Tigard, OR 97223
503.579.6621 | metpdx@metpdx.org | www.metpdx.org



*Fitness, Sports, Recreation,
Banquet and Meeting Facilities
for the Entire Family!*

COME JOIN US TODAY!



Welcome!

The **MET Community Center** located in Tigard, at 10330 SW Scholls Ferry Road, Tigard, OR 97223, is ideally situated, just thirteen minutes from downtown Portland, within easy access for community members and a short walking distance from Washington Square. The **MET Community Center** approximately 36,000 square feet in area, welcomes members of all faiths as we at **MET** have since our founding in 1993.

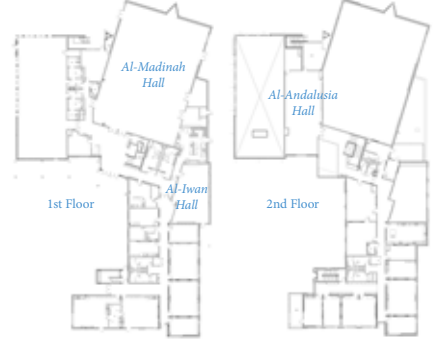

Membership Benefits

Your **MET Community Center** membership includes:

- Drop-in Sports during Open-Gym times*: Basketball, Volleyball, Badminton, Tennis, and Table Tennis
- Drop-in Swimming during Open-Swim times (25-yard 3-lane pool)**
- Drop-in use of Fitness & Cardio Center during open hours**
- Locker rooms with accessible lockers
- Drop-in use of Library during open hours
- Drop-in use of Outdoor Playground
- Family changing room
- 10% of facility rentals and private reservations
- 5% discount at Al-Iwan and MET partner businesses
- Discounted rates for classes and workshops
- Free parking
- ADA-accessible entrances, parking, pool, restrooms, and elevator

* Please note that private reservations may take away from open-gym time; check website for up-to-date schedule
 ** Separate schedule for men and women



Membership Rates

- Individual:** \$30/month ♦
- Family (up to 5 members):** \$100/month ♦
- Additional child:** \$20/month
- Guest Pass:** \$10 for 4 hours

■ 10% off Membership Rates for 1 year pre-payment
 ● 10% off Rental Rates for Members
 ♦ One-Time Initiation Fee:
 Individual: \$100
 Family: \$200

Hourly Event Rental Rates

- Al-Madinah Hall:** \$225/hour
 Banquet style - 600 people; Lecture style - 884 people
 - Al-Iwan Hall:** \$125/hour
 Banquet style - 74 people; Lecture style - 74 people
 - Al-Andalusia Hall:** \$150/hour
 Banquet style - 125 people; Lecture style - 240 people
- To use the kitchen for any event, add \$100**

Sports Rentals

- Gymnasium (Basketball, Volleyball):** \$85/hour
- Swimming Pool (includes lifeguard):**
 \$150/hour for up to 25 people; \$200/hour for 26-50 people

2-Hour Party Packages

- Pool Party:** 1 hour Swimming Pool + 1 hour Iwan Hall): \$250
- Gym Party:** 1 hour sports in Gymnasium + 1 hour Iwan Hall): \$190

Financial aid is available based on financial need; see financial aid form for more details.

For Wedding and Special Event Packages (10 hour Rentals), please call us at 503-579-6621. Al-Madinah Hall

Facilities

- Gymnasium: Basketball, Volleyball, Badminton, Tennis, and Table Tennis
- 3 Banquet Halls
- Indoor Swimming Pool
- Fitness Center
- Islamic Museum/Art Gallery
- Resource Library
- Technology/Media Lab
- Science Center
- Commercial Kitchen
- Coffee/Gift Shop
- 13 Classrooms
- Outdoor Playground

